

NOTES:

1. THIS DRAWING IS TO BE READ IN CONJUNCTION WITH OVERALL GROUND FLOOR DRAINAGE LAYOUT DRAWING NO. 152217-003.
2. ALL DIMENSIONS IN MILLIMETERS UNLESS NOTED OTHERWISE.
3. ALL LEVELS IN METERS RELATING TO MALIN HEAD ORDINANCE DATUM UNLESS NOTED OTHERWISE.
4. FOR DRAINAGE DETAILS REFER TO DRAWING NO. 152217-021.
5. FOR IRISH WATER DETAILS REFER TO DRAWING NO. 152217-022.

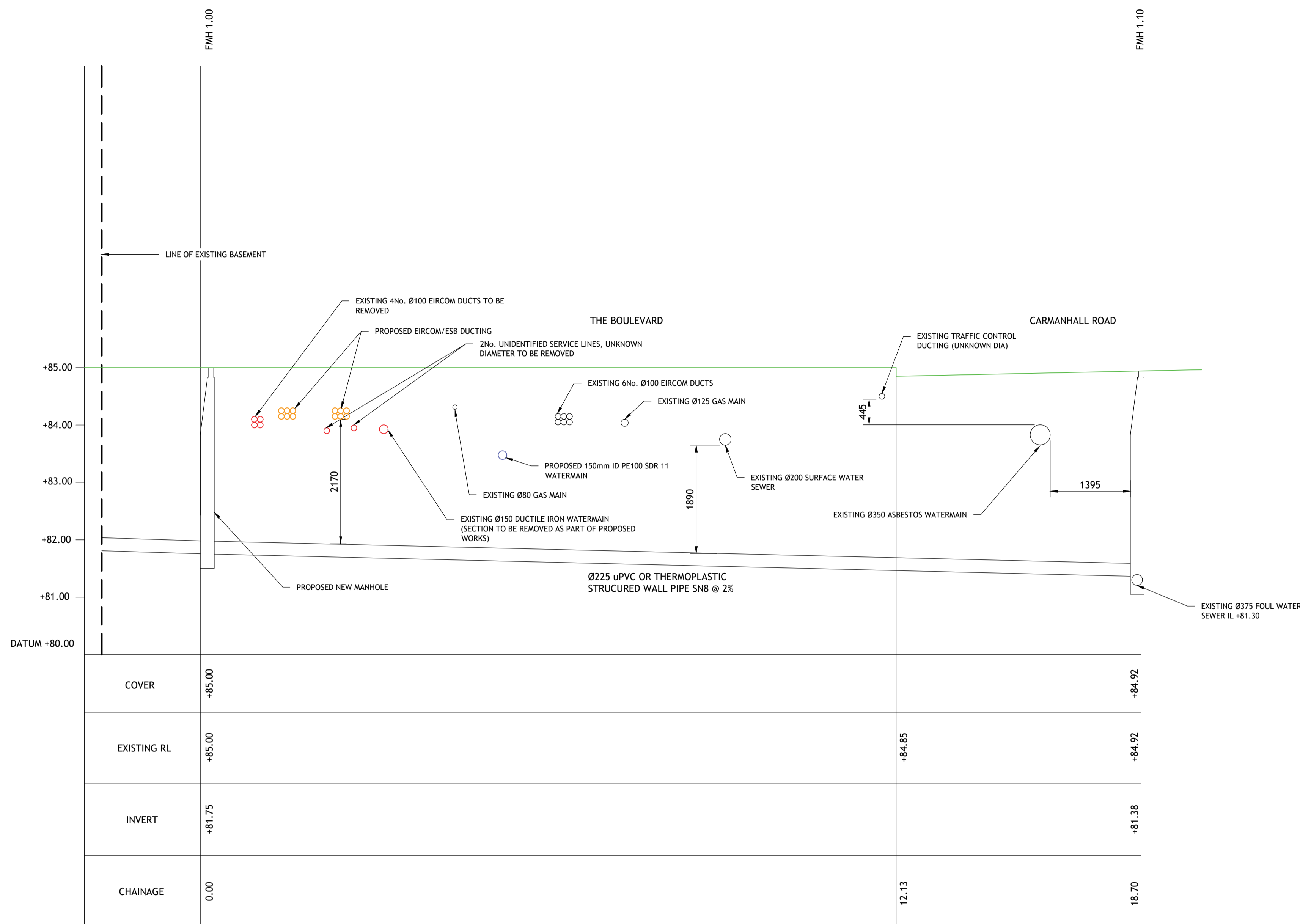

D PROPOSED FOUL WATER CONNECTION LONG SECTION
003 SCALE 1:50 HORIZONTAL & VERTICAL

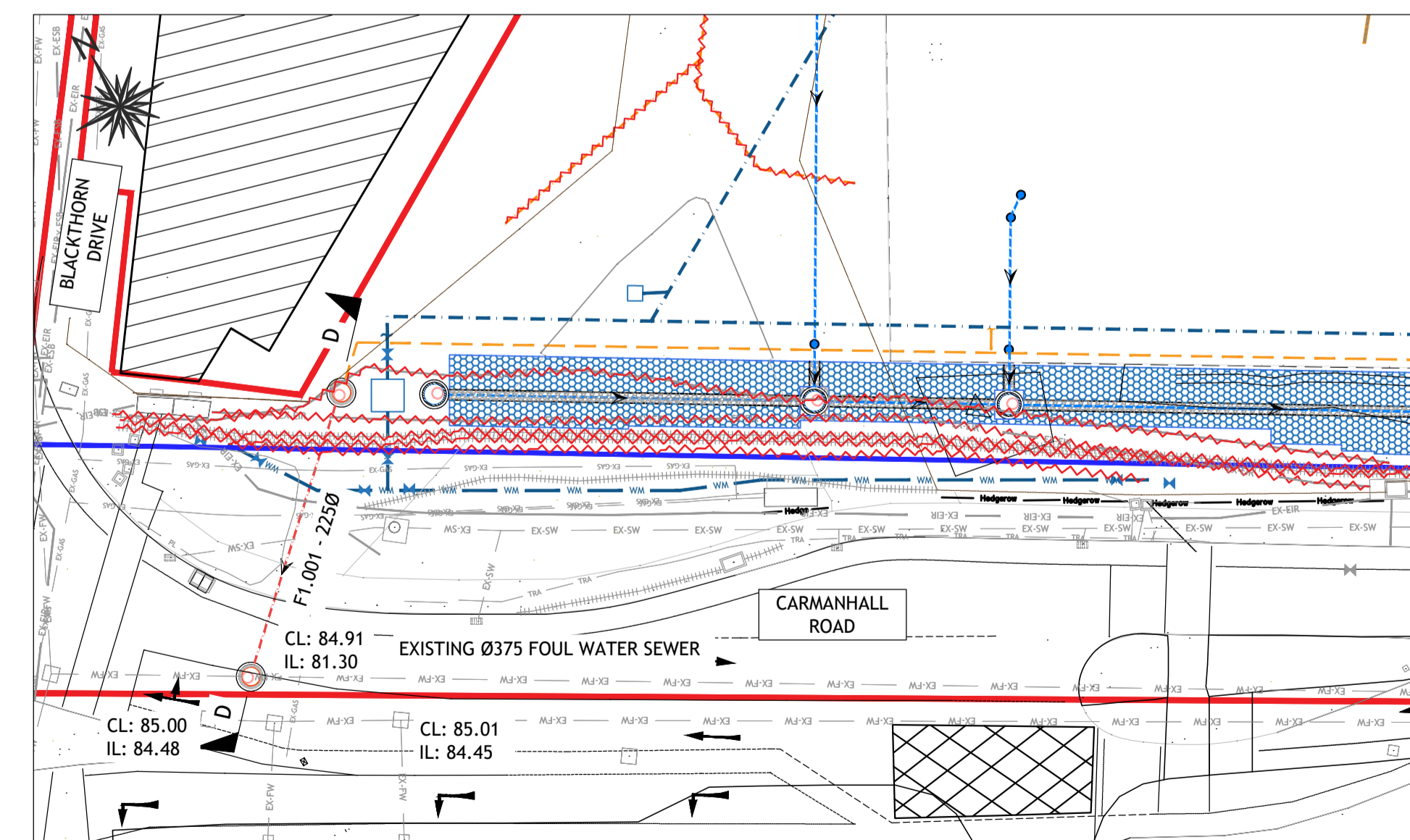

LOCATION PLAN
NOT TO SCALE

© PUNCH Consulting Engineers
This drawing and any design hereon is the copyright of the Consultants and must not be reproduced without their written consent. All drawings remain the property of the Consultants. Figured dimension only to be taken from this drawing. Consultants to be informed immediately of any discrepancies before work proceeds.

Date Drawn:	JULY 2018
Drawn By:	IBS
Date Issued:	2019/04/12
Issued By:	IBS

System Certified by BMTRADA (ISO 14001, ISO 9001, OHSAS 18001) and bsi BIM Verified Design & Construction Capital/Delivery PAS 1192-2.

Rev	Amendment	By	Date
PL0	ISSUED FOR PLANNING	IBS	2018/12/06
PL1	ISSUED FOR PLANNING	IBS	2019/03/25
PL2	ISSUED FOR PLANNING	IBS	2019/03/29
PL3	ISSUED FOR PLANNING	IBS	2019/04/05
PL4	ISSUED FOR PLANNING	IBS	2019/04/12

Client:
IRES Residential Properties LTD.

Job: LANDS KNOWN AS "RB CENTRAL" AT ROCKBROOK, CARMANHALL ROAD, SANDYFORD BUSINESS DISTRICT, SANDYFORD, DUBLIN 18
Title: PROPOSED FOUL WATER LONG SECTION

Dublin | Limerick | Cork | Galway | Glasgow
Carnegie House, Library Road, Dun Laoghaire, Co. Dublin, A96 C7W7
IRL: +353 1 271 2200 www.punchconsulting.com

Stage:	PLANNING
Scale @ A1:	AS SHOWN
Technician Check:	IBS
Engineer Check:	MR
Approved:	PC
Drawing No:	152217-014
Rev:	PL4